

## OMM Half couplings

### Type FL Ø 25 - 60 mm

Flange couplings manufactured in C45 steel, completely machined. The flange couplings are galvanically coated. The flange couplings have a taper of 1:10. The R indicated in the table represents the number of bolt holes in the flange.

All dimensions in mm.

A	H	D	L	La	Ph	I	Pu	St.C.	B	R	Cat. no.
25	3,3	102	77	50	3,0	12	63,5	82,50	8	4	25-FL-102
30	3,3	102	77	50	3,0	12	63,5	82,50	8	4	30-FL-102
35	3,3	102	94	60	3,0	14	63,5	82,50	10	4	35-FL-102
40	3,3	102	94	60	3,0	14	63,5	82,50	12	4	40-FL-102
35	3,3	121	94	60	3,0	14	63,5	98,42	10	6	35-FL-121
40	3,3	121	94	60	3,0	14	63,5	98,42	12	6	40-FL-121
45	3,8	121	111	75	4,5	16	63,5	98,42	14	6	45-FL-121
30	3,3	127	77	50	3,0	12	63,5	107,95	8	4	30-FL-127
35	3,3	127	94	60	3,0	14	63,5	107,95	10	4	35-FL-127
40	3,3	127	94	60	3,0	14	63,5	107,95	12	4	40-FL-127
45	3,8	127	111	75	4,5	16	76,2	107,95	14	4	45-FL-127
45	3,8	146	114	75	4,5	16	76,2	120,65	14	6	45-FL-146
50	3,8	146	111	75	3,0	16	76,2	120,65	14	6	50-FL-146
55	4,3	185	136	95	5,0	18	95,2	152,4	16	6	55-FL-185
60	4,4	185	136	95	5,0	18	95,2	152,4	18	6	60-FL-185

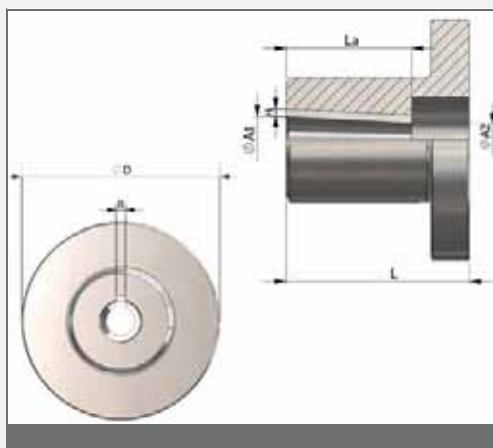

## Exalto Half couplings

### Fully machined steel flange couplings with keyway Ø 70 - 300 mm

On request, steel flange couplings can be machined completely or partly. When ordering, please specify the dimensions of the gearbox flange. The flange couplings have a standard tapered bore 1:10 and a keyway.

All dimensions in mm.

Other dimensions on request.

A1	D	L	La	A2	Key W x H	Cat. no. unmachined
70	200	185	145	55,5	18 x 5,5	74679
80	225	215	175	62,5	20 x 6,0	74681
90	225	215	175	72,5	22 x 6,0	74683
100	250	255	215	78,5	25 x 6,0	74685
110	250	255	215	88,4	28 x 7,5	74687
120	275	255	215	98,5	32 x 8,5	74689

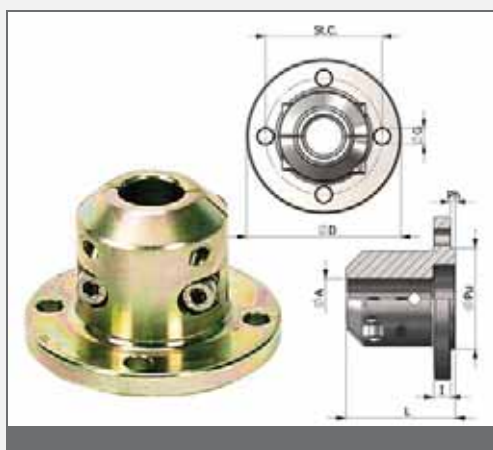

## Clamp-on couplings

## OMM Clamp-on couplings

### Type FLM

Designed by OMM, these clamp-on coupling flanges are manufactured in C45 steel and galvanically coated. The clamp-on couplings are completely machined and can be supplied in the dimensions mentioned in the table below. The R indicated in the table represents the number of bolt holes in the flange.

All dimensions in mm.

A	D	L	Pu	Ph	I	G	St.C.	R	Cat. no.
25	102	68	63,5	3	10,5	10,5	82,5	4	25-FM-102
30	102	68	63,5	3	10,5	10,5	82,5	4	30-FM-102
35	127	93	63,5	3	11,5	11,5	107,95	4	35-FM-127
40	127	93	63,5	3	11,5	11,5	107,95	4	40-FM-127

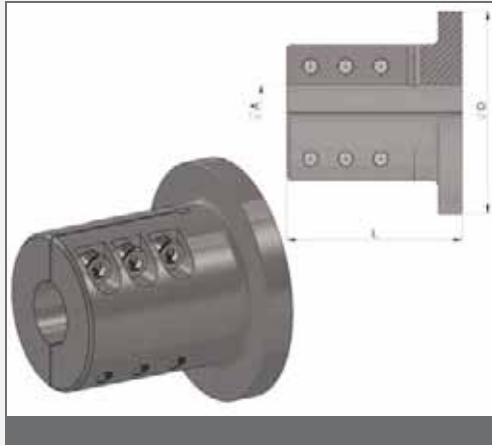

## Exalto Clamp-on couplings

Exalto clamp-on couplings are completely renewed. The design has been thoroughly revised and the price is much more attractive. Exalto clamp-on couplings are available in unmachined or completely machined flange. The flanges can be machined to suit the gearbox flange, Aquadrive thrust bearings (both input and output shaft) and all known gearboxes. In the last two columns in the table below are the item codes for clamping hub operation (so you may order these with your clamping hub). The installation dimensions of the machined flanges are slightly shorter than the length as specified in the table.

All dimensions in mm.  
Other dimensions on request.

A	D	L	Length clamping	Torque (Nm)	Cat. no. unmachined	Cat. no. machined
25	102	100	85	212	74525102	74525102.010
30	102	100	85	255	74530102	74530102.010
30	127	110	95	255	74530127	74530127.010
35	102	100	85	470	74535102	74535102.010
35	127	110	95	470	74535127	74535127.010
40	127	110	95	537	74540127	74540127.010
45	127	110	95	878	74545127	74545127.010
45	146	125	110	878	74545146	74545146.010
50	146	125	110	976	74550146	74550146.010

## Centa couplings

Centa offers the perfect, innovative marine transmission. It is a combination of well-proven designs with unique features – freedom in alignment and installation, together with damping of noise and vibration within the transmission. Centaflex couplings have one or more centaflex rubber elements. The rubber elements interrupt structure borne noises and dampen noise and vibrations for the highest level of comfort in the boat.

### Common features of Centaflex couplings

- Centa offers a broad range of rating and sizes.
- Short, lightweight design.
- Integrated prop shaft clamping device which can easily be adapted by intermediate bushes for an extensive range of propeller shaft diameters.
- Patented design.
- The thrust bearings have a spherical outer ring, which means they will always align themselves perfectly to the prop shaft for optimum bearing lifetime.

### Selection method

In the tables shown at each type of coupling, you will find four versions to choose from. To ease the selection of the right coupling, let us explain the specifics of each version.

#### Leisure craft (PL)

- Engine hours : up to 500 hours/year, max. 10% of time with full power.
- Usage : highly intermittent operation, varying speed and power.
- Typical applications : planing hull, private use, sailing boats, and motor boats.
- Not suitable for : charter or long range.

#### Light duty (LD)

- Engine hours : up to 2000 hours/year, max. 15% of time with full power.
- Usage : varying speed and power
- Typical applications : planing and semi-displacement hulls, charter sport / leisure activities, patrol boats, long range private boats.

#### Medium duty (MD)

- Engine hours : up to 3000 hours/year, max. 50% of time with full power.
- Usage : some variations in speed and power.
- Typical applications : semi- and full displacement hulls, charter and commercial craft, ferries, fishing boats, crew boats, naval and police boats.

#### Continuous duty (CD)

For more demanding or continuous duty please consult the experts of Exalto.

Calculating the nominal torque:  $M(Nm) = \frac{9550 \times P \times R}{n}$

M = Nominal torque

P = Engine rating in kW (1 hp = 0.735 kW)

R = Gearbox ratio

n = engine rpm

The range of small Centaflex couplings consists of types M, AM, AGM and ACV.

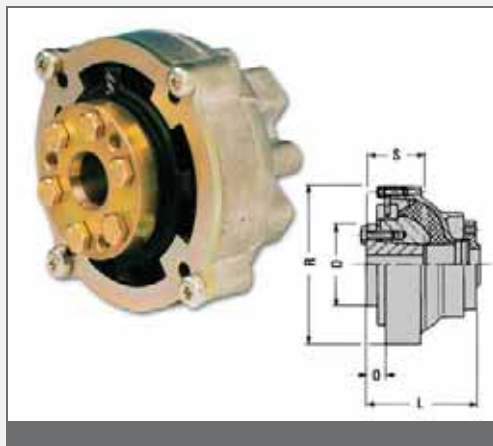

## Centa Couplings

### Type M

The Centaflex M coupling is a flexible coupling especially designed for yachts where vibration reduction is essential. The design allows the coupling to transmit the propeller thrust. The coupling type M 127 has a 4" flange as a standard, whereas the coupling type M 160 comes standard with a combined 4" and 5" flange. Please contact one of our specialists for the exact sizes and dimensions.

A clamp-on coupling Ø25 or 30mm is included with all the Yanmar types.

Flange diameter	Lead-in edge (female)	St.C.	No. of holes x Ø
4" - 102 mm	63,5	82,5	4 x 10,5 mm
Yanmar 4" - 102 mm	50,0	78,0	4 x M10
5" - 127 mm	63,5	107,9	4 x 11,2 mm

All dimensions in mm.

Type	Connection	Diam. shaft min-max	L	S	Ø	ØR	ØD	Max. rpm	Max. nom. torque (Nm) PL	Max. angle (°)	Max. kN thrust	Cat. no.
M 127	std 4"	25 - 35	89	53	11	153	73	4500	250	2	10	94701
M 127	Yanmar 4"	25	89	53	11	153	73	4500	250	2	10	94701.025YAN
M 127	Yanmar 4"	30	89	53	11	153	73	4500	250	2	10	94701.030YAN
M 160	std 4" and 5"	25 - 40	120	79	13	195	100	3500	500	2	20	94702

## Centa Adapter flange

These handy adapter flanges come with 4 allen bold M10 for mounting on the Centa coupling.

New

Type	Description	Cat. no.
M127 - 2.3 Yanmar 5"	Adapter flange Stc. 100mm 4x M8. spigot 65mm	94701F.2.3
M127 - 3.2 Volvo 4"	Adapter flange Stc. 80 mm 4x M8. spigot 60mm	94701F.3.2



## Exalto Spacer

A Centa coupling is not always directly mountable to the gearbox flange. In that case, a steel spacer is necessary. Below there are three examples of commonly used sizes. Customization is possible.

Diameter (mm)	Length (mm)
100	100
125	125
150	150

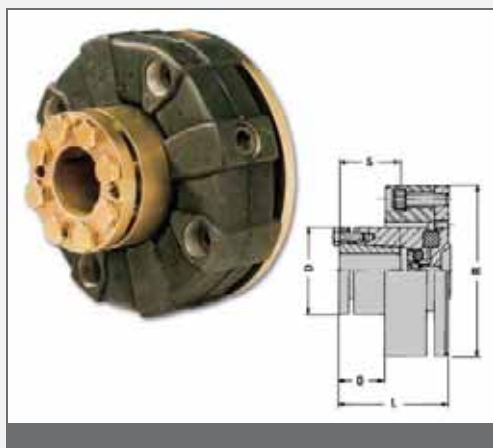

## Centa Couplings

### Type AM

The AM coupling is a highly flexible coupling especially designed for yachts and workboats. The couplings have a fail-safe device, which ensures that power can continue to be transmitted even if the rubber fails. The coupling comes with a thrust element that allows the coupling to transmit the propeller thrust. If a thrust bearing is placed after the coupling, this thrust element has to be removed.

Mounting on the gearbox

The AM coupling is machined to fit the gearbox flange. It is therefore important that the exact make and type of the gearbox is given. For some gearboxes, the diameter of the rubber element ( $\text{ØR}$ ) exceeds the available space. A distance piece (spacer) must then be placed between the coupling and the gearbox flange. This spacer is not included, but can be ordered separately.

All dimensions in mm.

Type	Diam. shaft min-max	L	S	O	$\text{ØR}$	$\text{ØD}$	Max. rpm	Max. nom. Moment (Nm) PL	LD	Max. kN thrust	Max. angle (°)	CD	Cat. no.	
AM 12	25 - 35	99	57	51	120	75	4000	175	135	5,5	2	o.r.	94703	
AM 22	25 - 35	99	57	41	150	80	4000	350	269	7,5	2	o.r.	94704	
AM 28	25 - 40	100	55	41	170	85	4000	525	404	10,00	3	o.r.	94705	
AM 30	25 - 50	125	70	51	200	100	4000	625	481	10,00	3	o.r.	94710	
AM 50	25 - 50	125	70	51	200	100	4000	1000	769	10,00	2	o.r.	94720	
AM 80	25 - 50	125	70	44	205	100	4000	1400	1077	15,00	2	o.r.	94730	
AM 140	25 - 60	138	83	48	260	125	3600	1875	1422	20,00	2	o.r.	94740	
AM 200	25 - 70	160	90	50	300	145	3200	3100	2385	30,00	2	o.r.	94750	
AM 250	25 - 80	172	100	60	340	160	3000	4000	3077	35,00	2	o.r.	94760	
AM 400	25 - 100	199	120	67	370	170	2500	7500	5769	35,00	2	o.r.	94770	
AM 600	25 - 100	Mounting sizes on request						2500	11000	8462	50,00	2	o.r.	94780



## Centa Couplings

### Type AGM

The AGM coupling is a highly flexible coupling combined with a thrust bearing. It is a combination of well-proven design with unique features – freedom in alignment and installation, together with dampening of noise and vibration within the transmission. The thrust free mounting of the engine on very soft mounts, together with the flexibility and the high dampening of the transmission, provides the lowest possible level of noise and vibration in the drive train, lower than any other system.

#### Mounting on the gearbox

The AGM coupling is machined to fit the gearbox flange. Therefore it is important that the exact make and type of the gearbox is given. For some gearboxes, the diameter of the rubber element ( $\emptyset R$ ) exceeds the available space. A distance piece (spacer) must than be placed between the coupling and the gearbox flange. This spacer is not included but can be ordered separately.

All dimensions in mm.

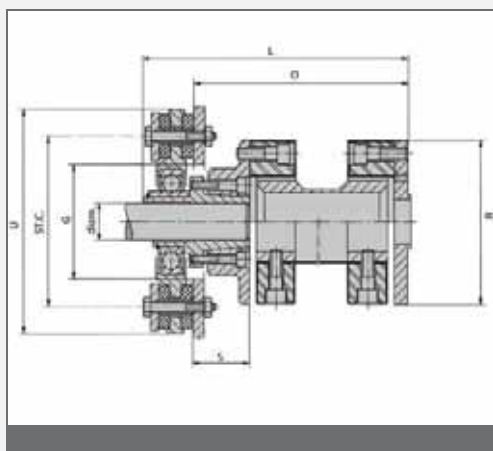

Type	Diam. shaft min-max	L	S	O	ØR	U	Pitch	ØG	Max. rpm	MD	CD	Max. kN thrust	LD	Cat. no.	
AGM 16	20 - 35	209	48,5	169,5	120	197	145	102	4000	100	o.r.	8	123	94802	
AGM 16	20 - 35	231	48,5	191,5	150	197	145	102	4000	200	o.r.	8	246	94803	
AGM 25P	20 - 35	249	48,5	209,5	170	197	145	102	4000	-	-	8	308	95804	
AGM 25	20 - 40	267	65,0	226,0	170	197	145	102	4000	250	o.r.	10	308	94804	
AGM 30P	20 - 40	285	48,5	245,5	200	197	145	102	3500	-	-	8	481	95810	
AGM 30	20 - 40	303	65,0	262,0	200	197	145	102	3500	391	o.r.	10	481	94810	
AGM 50P	20 - 40	303	65,0	262,0	200	197	145	102	3000	-	-	10	769	95820	
AGM 50	35 - 50	330	69,5	266,5	200	277	211	140	3000	625	o.r.	14	769	94820	
AGM 80P	30 - 40	306	65,0	265,0	205	197	145	102	2500	-	-	10	1077	95830	
AGM 80	35 - 50	333	69,5	269,5	205	277	211	140	2500	875	o.r.	14	1077	94830	
AGM 140P	35 - 50	384	69,5	320,5	260	227	211	140	2000	-	-	14	1442	95840	
AGM 140	35 - 60	411	82,0	333,0	260	284	216	160	2000	1172	o.r.	24	1442	94840	
AGM 200P	35 - 60	426	82,0	348,0	300	284	216	160	2000	-	-	24	2385	95850	
AGM 200	50 - 80	474	108,0	374,0	300	346	277	210	2000	1938	o.r.	40	2385	94850	
AGM 250	50 - 80	499	108,0	399,0	340	346	277	210	1800	2500	o.r.	40	3077	94860	
AGM 400	50 - 127	Mounting sizes on request								1600	4688	o.r.	80	5769	94870
AGM 600	50 - 165	Mounting sizes on request								1400	6875	o.r.	120	8462	94880



## Centa Couplings

### Type ACV

The ACV is a combination with a CV (constant velocity or homokinetic) joint on one side and a flexible coupling on the other side. Just like the AGM the ACV also incorporates a thrust bearing. The combination of the CV joint with the flexible coupling gives the vibration and noise dampening features of a flexible coupling and the unsurpassed freedom of movement and large angle of a homokinetic shaft. It is ideal for larger angles, up to 8 degrees in the CV (b) plus up to 2 or 3 degrees in the rubber element (a).

Please take notice that a minimum angle has to be made, like in every other homokinetic coupling!

Mounting on the gearbox

The ACV comes complete with an adapter flange to suit the gearbox. Design and dimensions depend on the type of gearbox. It is therefore important that the exact make and type of the gearbox is given.

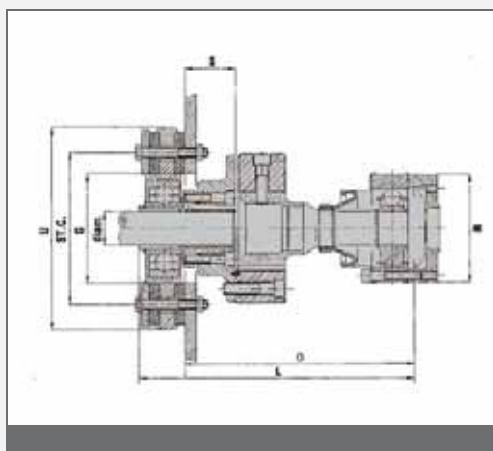

All dimensions in mm.

Type	Diam. shaft min-max	L	S	O	ØR	U	Pitch	ØG	Max. rpm	MD	CD	Max. kN thrust	LD	Cat. no.	
ACV 08	20 - 35	211	48,5	171,5	90	197	145	102	4000	100	o.r.	8	123	94902	
ACV 16	20 - 35	243	48,5	203,5	97	197	145	102	4000	200	o.r.	8	246	94903	
ACV 25P	20 - 35	269	48,5	229,5	103	197	145	102	4000	-	-	8	308	95904	
ACV 25	20 - 40	287	65,0	246,0	103	197	145	102	4000	250	o.r.	10	308	94904	
ACV 30P	20 - 40	286	48,5	246,5	110	197	145	102	3500	-	-	8	481	95910	
ACV 30	20 - 40	304	65,0	263,0	110	197	145	102	3500	391	o.r.	10	481	94910	
ACV 50P	20 - 40	303	65,0	262,0	130	197	145	102	3000	-	-	10	769	95920	
ACV 50	35 - 50	330	69,5	266,5	130	277	211	140	3000	625	o.r.	14	769	94920	
ACV 80P	30 - 40	343	65,0	302,0	151	197	145	102	2500	-	-	10	1077	95930	
ACV 80	35 - 50	370	69,5	306,5	150	277	211	140	2500	875	o.r.	14	1077	94930	
ACV 140P	35 - 50	413	69,5	349,5	186	227	211	140	2000	-	-	14	1442	95940	
ACV 140	35 - 60	440	82,0	362,0	186	284	216	160	2000	1172	o.r.	24	1442	94940	
ACV 200P	35 - 60	444	82,0	366,0	200	284	216	160	2000	-	-	24	2385	95950	
ACV 200	50 - 80	492	108,0	392,0	200	346	277	210	2000	1938	o.r.	40	2385	94950	
ACV 250	50 - 80	596	108,0	496,0	285	346	277	210	1800	2500	o.r.	40	3077	94960	
ACV 400	50 - 127	Mounting sizes on request								1600	4688	o.r.	80	5769	94970
ACV 600	50 - 165	Mounting sizes on request								1400	6875	o.r.	120	8462	94980



Alignment of engines is often a problem. First for the shipbuilder, later on for the owner. Each engine vibrates. Ships suffer from the vibrations, passed through the foundation to the hull. In addition, vibrations are very uncomfortable for the crew.

Aquadrive couplings ensure that the motor is not affected by the propeller and it has its own freedom of movement. Furthermore, the alignment of the engine is relatively easy to perform.

Aquadrive couplings consist of a CV joint, a thrust bearing and an adapter flange. The CV joint consists of two universal joints connected by a floating axle, which allows axial and radial movements. The thrust bearing transfers the thrust of the propeller through a rubber suspension on the foundation of the craft instead of the gearbox.

The Aquadrive Moduline is modular, allowing the overall length to be reduced to 70% and the weight to 75%. The Moduline consists of a thrust bearing being connected to the shaft by a sleeve set. The joint is attached to the thrust bearing with an adapter at one side and connected to the gearbox on the other side with an adapter flange. There is a gearbox adapter available for all existing gearboxes. Aquadrive Moduline couplings are available for power between 5 and 235 hp.

The descriptions in this catalog are provided as a guide. Based on data of your boat and motor Exalto can provide the most suitable Aquadrive coupling.



## Aquadrive CVB05.05 Moduline

Ø head cv shaft : 86 mm  
Pitch of bolts : 74 mm

Part	Description	Cat.no.
CV shaft	CV shaft CV05 WL = 130 mm	6070001
	CV shaft lengthened CV05 WL = till 1000 mm	6070005
	Repairkit CV joint CV 05 (1 side)	6036002
Thrust bearing unit	Moduline B05 CV shaft 20 mm	6100201
	Moduline B05 CV shaft 22 mm	6100202
	Moduline B05 CV shaft 25 mm	6100204
	Moduline B05 CV shaft 1"	6100205
	Moduline B05 CV shaft 30 mm	6100207
Adapter flange	Dimensions and price on request	

## Aquadrive CVB05.10 Moduline

Ø head cv shaft : 86 mm  
Pitch of bolts : 74 mm

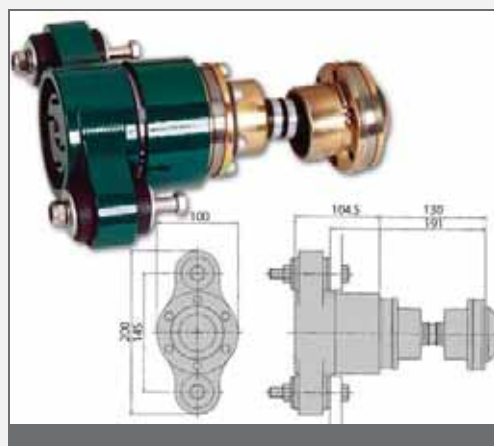

Part	Description	Cat.no.
CV shaft	CV shaft CV05 WL = 130 mm	6070001
	CV shaft lengthened CV05 WL = till 1000 mm	6070005
	Repairkit CV joint CV 05 (1 side)	6036002
Thrust bearing unit	Moduline B10 thrust bearing unit	6110000
CV Adapter set	Adapter kit - B10 - CV05	6116011
Clamping sleeve set	Clamping sleeve set 20 mm	6111013
	Clamping sleeve set 25 mm	6111016
	Clamping sleeve set 30 mm	6111019
	Clamping sleeve set 35 mm	6111022
	Clamping sleeve set 40 mm	6111024
Thrust bearing unit	Pre-assembled, CVB.05.10 propeller shaft 30 mm	6110207
Adapter flange	Dimensions and price on request	

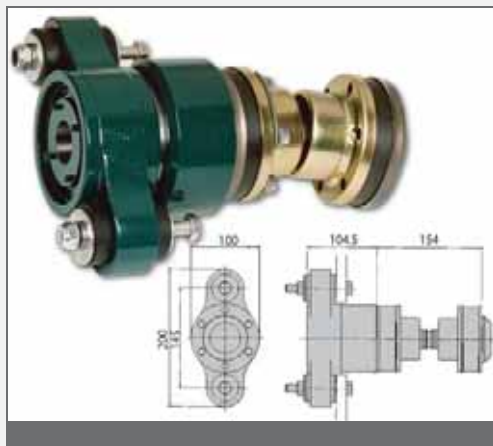

## Aquadrive CVB10.10 Moduline

Ø head cv shaft : 94 mm  
Pitch of bolts : 80 mm

Part	Description	Cat.no.
CV shaft	CV shaft CV10 WL = 154 mm	6070006
	CV shaft lengthened CV joint CV10 WL = till 1000 mm	6070019
	Repairkit CV joint CV 05 (1 side)	6036004
Thrust bearing unit	Moduline B10 thrust bearing unit	6110000
CV Adapter set	Adapter kit - B10 - CV10	6116012
Clamping sleeve set	Clamping sleeve set 20 mm	6111013
	Clamping sleeve set 25 mm	6111016
	Clamping sleeve set 30 mm	6111019
	Clamping sleeve set 35 mm	6111022
	Clamping sleeve set 40 mm	6111024
Thrust bearing unit	Pre-assembled, CVB.10.10 propeller shaft 25 mm	6110304
	Pre-assembled, CVB.10.10 propeller shaft 30 mm	6110307
	Pre-assembled, CVB.10.10 propeller shaft 35 mm	6110310
	Pre-assembled, CVB.10.10 propeller shaft 40 mm	6110312
Adapter flange	Dimensions and price on request	

## Aquadrive CVB15.10 Moduline

Ø head cv shaft : 108 mm  
Pitch of bolts : 94 mm

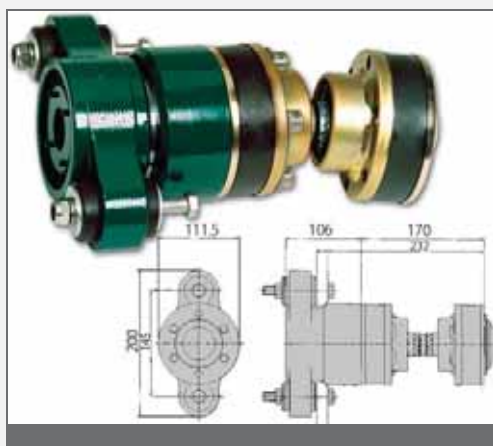

Part	Description	Cat.no.
CV shaft	CV shaft CV15 WL = 170 mm	6070025
	CV shaft lengthened CV15 WL = till 1000 mm	6070035
	Repairkit CV joint CV 15 (1 side)	6036011
Thrust bearing unit	Moduline B10 thrust bearing unit	6110000
CV Adapter set	Adapter kit - B10 - CV15	6116013
Clamping sleeve set	Clamping sleeve set 20 mm	6111013
	Clamping sleeve set 25 mm	6111016
	Clamping sleeve set 30 mm	6111019
	Clamping sleeve set 30 mm	6111022
	Clamping sleeve set 40 mm	6111024
Thrust bearing unit	Pre-assembled, CVB.15.10 propeller shaft 30 mm	6110407
	Pre-assembled, CVB.15.10 propeller shaft 35 mm	6110410
	Pre-assembled, CVB.15.10 propeller shaft 40 mm	6110412
Thrust bearing unit set	Complete set thrust bearing unit 45 mm	6110424
	Complete set thrust bearing unit 50 mm	6110426
Adapter flange	Dimensions and price on request	

## Aquadrive CVB21.10 Moduline

Ø head cv shaft : 128 mm  
Pitch of bolts : 108 mm

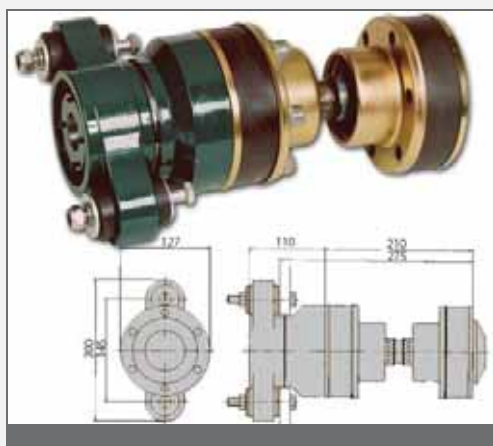

Part	Description	Cat.no.
CV shaft	CV shaft CV21 WL = 210 mm	6070040
	CV shaft lengthened CV21 WL = till 1000 mm	6070049
	Repairkit CV joint CV 21 (1 side)	6036015
Thrust bearing unit	Moduline B10 thrust bearing unit	6110000
CV Adapter set	Adapter kit - B10 - CV21	6116014
Clamping sleeve set	Clamping sleeve set 20 mm	6111013
	Clamping sleeve set 25 mm	6111016
	Clamping sleeve set 30 mm	6111019
	Clamping sleeve set 35 mm	6111022
	Clamping sleeve set 40 mm	6111024
Thrust bearing unit	Pre-assembled, CVB.21.10 propeller shaft 30 mm	6110507
	Pre-assembled, CVB.21.10 propeller shaft 35 mm	6110510
	Pre-assembled, CVB.21.10 propeller shaft 40 mm	6110512
Thrust bearing unit set	Complete set thrust bearing unit 45 mm	6110524
	Complete set thrust bearing unit 50 mm	6110526
Adapter flange	Dimensions and price on request	



## Aquadrive CVB21.20 Moduline

Ø head CV joint : 128 mm  
Bolt pitch circle : 108 mm  
Maximum compression rubber : 2,7 at 7 kN  
Max. alignment error CV joint : 2 x 8°

Part	Description	Cat.no.
CV shaft	CV shaft CV21 - 20.300 WL = 210 mm	6070040
	CV shaft lengthened 20.300 WL = till 1000 mm	6070049
	Repairkit CV joint CV 21 (1 side)	6036015
Thrust bearing unit	Moduline B20 thrust bearing unit	6120000
CV Adapter set	Adapter kit - B10 for CV21 drive shaft 72.6	6126011
Clamping sleeve set	Clamping sleeve set 35 mm	6121010
	Clamping sleeve set 40 mm	6121012
	Clamping sleeve set 45 mm	6121014
	Clamping sleeve set 50 mm	6121016
Flange	Flange kit	6123029
Adapter flange	Dimensions and price on request	

## Aquadrive CVB30.20 Moduline

Ø head CV joint : 148 mm  
Bolt pitch circle : 128 mm  
Maximum compression rubber : 2,7 at 7 kN  
Max. alignment error CV joint : 2 x 8°

Part	Description	Cat.no.
CV shaft	CV shaft CV30 - 20.400 WL = 245 mm	6070090
	CV shaft lengthened CV30 WL = till 1000 mm	6070095
	Repairkit CV joint CV30 (1 side)	6036018
Thrust bearing unit	Moduline B20 thrust bearing unit	6120000
CV Adapter set	Adapter kit - B20 - CV30	6126012
Clamping sleeve set	Clamping sleeve set 35 mm	6121010
	Clamping sleeve set 40 mm	6121012
	Clamping sleeve set 45 mm	6121014
	Clamping sleeve set 50 mm	6121016
Flange	Flange kit	6123029
Adapter flange	Dimensions and price on request	

## Aquadrive CVB30.30 Moduline

Ø head CV joint : 148 mm  
Bolt pitch circle : 128 mm  
Maximum compression rubber : 1,3 at 9 kN  
Max. alignment error CV joint : 2 x 8°

Part	Description	Cat.no.
CV shaft	CV shaft CV30 WL = 245 mm	6070090
	CV shaft lengthened CV30 WL = till 1000 mm	6070095
	Repairkit CV joint CV30 (1 side)	6036018
Thrust bearing unit	Moduline B30 thrust bearing unit	6130000
CV Adapter set	Adapter kit - B30 - CV30	6136011
Clamping sleeve set	Clamping sleeve set 40 mm	6131012
	Clamping sleeve set 45 mm	6131014
	Clamping sleeve set 50 mm	6131016
	Clamping sleeve set 55 mm	6131018
	Clamping sleeve set 60 mm	6131020
	Clamping sleeve set 65 mm	6131023
Flange	Flange kit	6123029
Adapter flange	Dimensions and price on request	

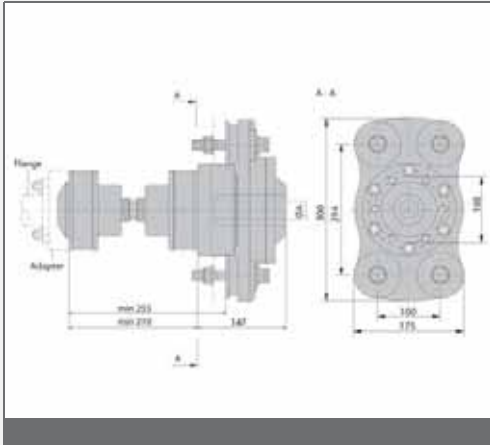



## AquaDrive CVB42.30 Moduline

Ø head cv shaft : 148 mm  
Pitch of bolts : 128 mm

Part	Description	Cat.no.
CV shaft	CV shaft CV42 - 20.600 WL = 274 mm	6070083
	CV shaft lengthened CV42 WL = till 1000 mm	6070087
	Repairkit CV joint CV42 (1 side)	6036020
Thrust bearing unit	Moduline B30 thrust bearing unit	6130000
CV Adapter set	Adapter kit - B30 - CV42	6136015
Clamping sleeve set	Clamping sleeve set 40 mm	6131012
	Clamping sleeve set 45 mm	6131014
	Clamping sleeve set 50 mm	6131016
	Clamping sleeve set 55 mm	6131018
	Clamping sleeve set 60 mm	6131020
	Clamping sleeve set 65 mm	6131023
Flange	Flange kit	6123029
Adapter flange	Dimensions and price on request	

## AquaDrive HD-couplings

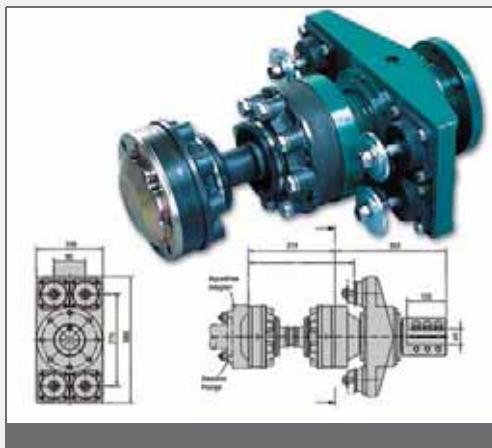

## AquaDrive HDL42.680

Part	Description	Cat.no.
CV shaft	CV shaft CV42 - 20.600	6070083
	CV Shaft lengthened CV42 WL = 1000 mm	6070087
Thrust bearing unit	Thrust bearing unit 20.680 Ø 60 mm	6039209A
	Thrust bearing unit 20.680 Ø 70 mm	6039212A
	Thrust bearing unit 20.680 flange / flange	6039220A
Adapter flange	Dimensions and price on request	

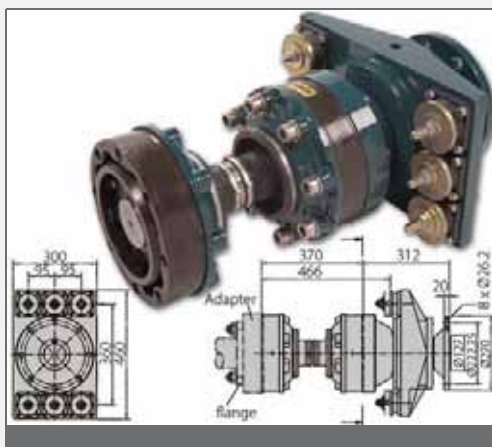

## AquaDrive HDL 60.700 / 60.780

Part	Description	Cat.no.
CV shaft	CV shaft CV60 - 20.700	6070100
	CV Shaft lengthened CV60 WL = 1000 mm	6070108
Thrust bearing unit	Thrust bearing unit 20.700 Ø 60 mm	6039309
	Thrust bearing unit 20.700 flange 7 1/2"	6039312
	Thrust bearing unit 20.700 flange 10 1/2"	6039320
	Thrust bearing unit 20.700 flange 10 1/2"	6039519
Adapter flange	Dimensions and price on request	

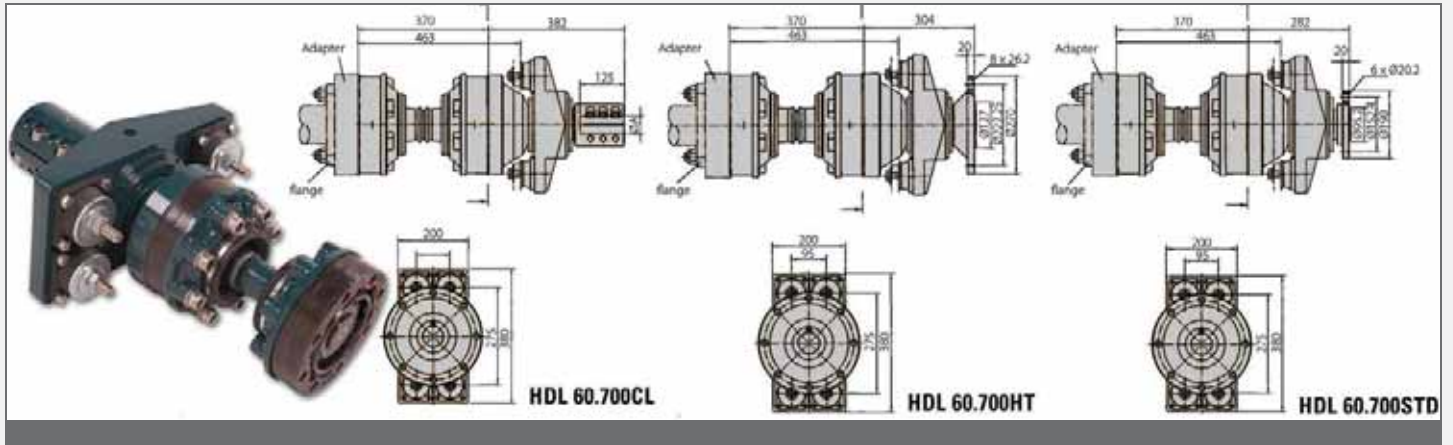

## Aquadrive Parts

Part	Description	Cat.no.
CV shaft	CV shaft CV60 - 20.700	6122000
	CV Shaft lengthened CV60 WL = 1000 mm	6132000
Thrust bearing unit	Thrust bearing unit 20.700 Ø 60 mm	6190001
	Thrust bearing unit 20.700 flange 7 1/2"	6190002
	Thrust bearing unit 20.700 flange 10 1/2"	6190003

The Python-drive is a complete drive system for yachts, pinnaces, barges, et cetera. With a Python-drive installed you will eliminate the need for alignment of propeller shaft and gearbox/engine. Axial movement caused by the propellers' thrust are eliminated and the thrust is passed onto the hull by means of the special suspension of the trust unit. The maintenance-free cv shaft forms the heart of every Python-drive.

The heavily built thrust bearing unit is also maintenance-free. The thrust bearing unit is mounted by means of a clamping sleeve. This sleeve centres the propeller shaft where it should be centred; right after the cv shaft of the Python-drive. The cv shaft ensures a constant rpm of the propeller shaft, even at uneven angles, which decreases the wear of rotating parts in the propulsion system. Another big advantage is the very limited built-in length the Python-drive needs. The unit is supplied complete with all needed mounting gear, such as an adapte adapter flange for most common gearbox types, a cv shaft, a robust thrust bearing unit and all bolts, (locking) nuts, and rubbers to take the thrust. For 19 mm up to 100 mm (and imperial sizes), complete units are available. Conical shaft sleeves are also an option. CV shafts for torques up to 1.500 Kgm (14.7 kNm) as well as longer or custom-made shafts are also available on request. Thrust bearing units can be supplied as separate units to be mounted on any position on the propeller shaft.



## Python-Drive P30-R

The Python-drive is supplied with a built-in length of 145 mm as a standard. Without a surcharge we can also offer built-in lengths of 165 or 195 mm. Please state the desired built-in length when you order your P30-R.

Ø head cv shaft : 100 mm  
Pitch of bolts : 86 mm

Max. shaft torque (Kgm - Nm)	Shaft Ø (mm) (min - max)	Max. prop. thrust (kN)	Usage	Cat.no.
30 - 294	19 - 30	4.3	50 HP/3000 rpm; 2.5:1 gearbox	P30-R
CV-shaft only (145 mm)				P30.145
CV-shaft only (165 mm)				P30.165
CV-shaft only (195 mm)				P30.195



## Python-Drive P60-B

The Python-drive is supplied with a built-in length of 145 mm as a standard. Without a surcharge we can also offer built-in lengths of 165 or 195 mm. Please state the desired built-in length when you order your P60-B.

Ø head cv shaft : 100 mm  
Pitch of bolts : 86 mm

Max. shaft torque (Kgm - Nm)	Shaft Ø (mm) (min - max)	Max. prop. thrust (kN)	Usage	Cat.no.
60 - 588	1 1/4 - 40	5.7	70 HP/2600 rpm; 3:1 gearbox	P60-B
CV-shaft only (145 mm)				P60.145
CV-shaft only (165 mm)				P60.165
CV-shaft only (195 mm)				P60.195

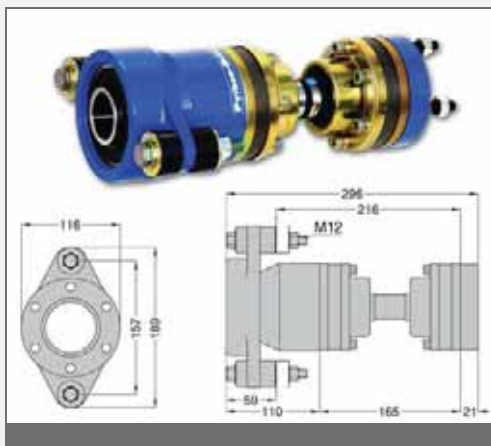

## Python-Drive P60-K

The Python-drive is supplied with a built-in length of 165 mm as a standard. Without a surcharge we can also offer built-in lengths of 145 or 195 mm. Please state the desired built-in length when you order your P60-K.

Ø head cv shaft : 100 mm  
Pitch of bolts : 86 mm

Max. shaft torque (Kgm - Nm)	Shaft Ø (mm) (min - max)	Max. prop. thrust (kN)	Usage	Cat.no.
60 - 588	30 - 40	5.7	70 HP/2600 rpm; 3:1 gearbox	P60-K
CV-shaft only (145 mm)				P60.145
CV-shaft only (165 mm)				P60.165
CV-shaft only (195 mm)				P60.195

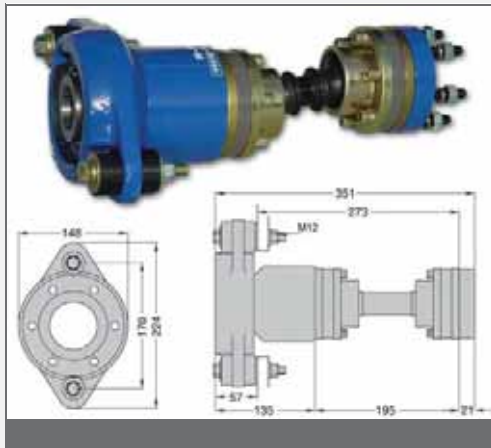

## Python-Drive P80-M

The Python-drive is supplied with a built-in length of 195 mm as a standard. Without a surcharge we can also offer built-in lengths of 145 or 165 mm. Please state the desired built-in length when you order your P80-M.

Ø head cv shaft : 100 mm  
Pitch of bolts : 86 mm

Max. shaft torque (Kgm - Nm)	Shaft Ø (mm) (min - max)	Max. prop. thrust (kN)	Usage	Cat.no.
80 - 785	30 - 45	8	105 HP/3000 rpm; 3:1 gearbox	P80-M
CV-shaft only (145 mm)				P80.145
CV-shaft only (165 mm)				P80.165
CV-shaft only (195 mm)				P80.195

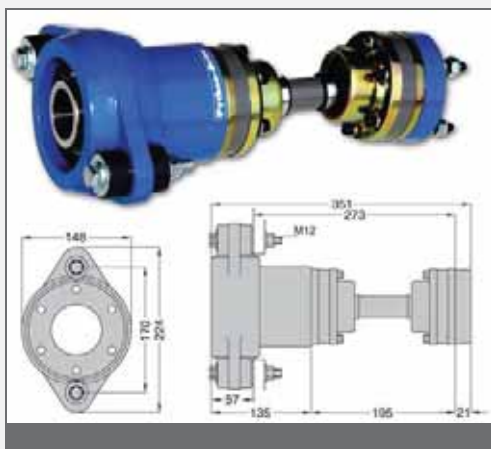

## Python-Drive P80-S

The Python-drive is supplied with a built-in length of 195 mm as a standard. Without a surcharge we can also offer built-in lengths of 145 or 165 mm. Please state the desired built-in length when you order your P80-S.

Ø head cv shaft : 100 mm  
Pitch of bolts : 86 mm

Max. shaft torque (Kgm - Nm)	Shaft Ø (mm) (min - max)	Max. prop. thrust (kN)	Usage	Cat.no.
80 - 785	30 - 45	12	135 HP/2500 rpm; 2:1 gearbox	P80-S
CV-shaft only (145 mm)				P80.145
CV-shaft only (165 mm)				P80.165
CV-shaft only (195 mm)				P80.195

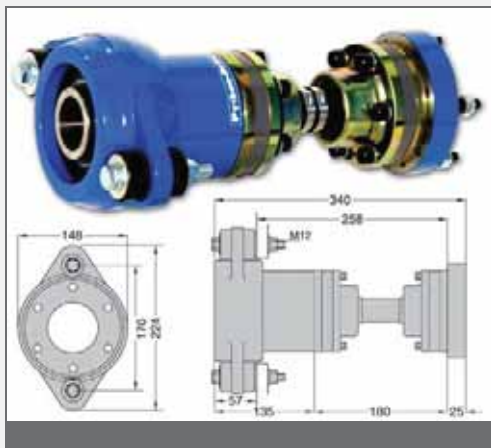

## Python-Drive P110-S

The Python-drive is supplied with a built-in length of 180 mm as a standard. Without a surcharge we can also offer a built-in length of 225 mm. Please state the desired built-in length when you order your P110-S.

Ø head cv shaft : 108 mm  
Pitch of bolts : 94 mm

Max. shaft torque (Kgm - Nm)	Shaft Ø (mm) (min - max)	Max. prop. thrust (kN)	Usage	Cat.no.
110 - 1080	35 - 45	12	135 HP/2800 rpm; 3:1 gearbox	P110-S
CV-shaft only (180 mm)				P110.180
CV-shaft only (225 mm)				P110.225

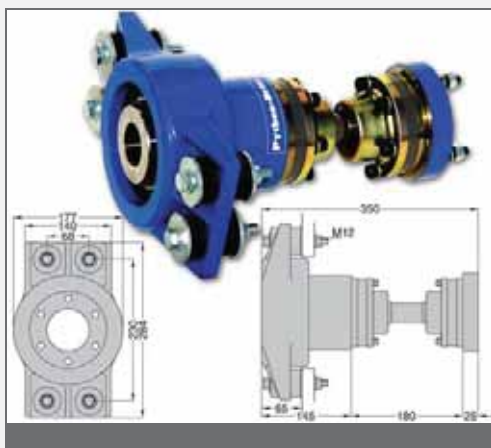

## Python-Drive P110-T

The Python-drive is supplied with a built-in length of 180 mm as a standard. Without a surcharge we can also offer a built-in length of 225 mm. Please state the desired built-in length when you order your P110-T.

Ø head cv shaft : 108 mm  
Pitch of bolts : 94 mm

Max. shaft torque (Kgm - Nm)	Shaft Ø (mm) (min - max)	Max. prop. thrust (kN)	Usage	Cat.no.
110 - 1080	35 - 50	18	175 HP/2400 rpm; 2:1 gearbox	P110-T
CV-shaft only (180 mm)				P110.180
CV-shaft only (225 mm)				P110.225

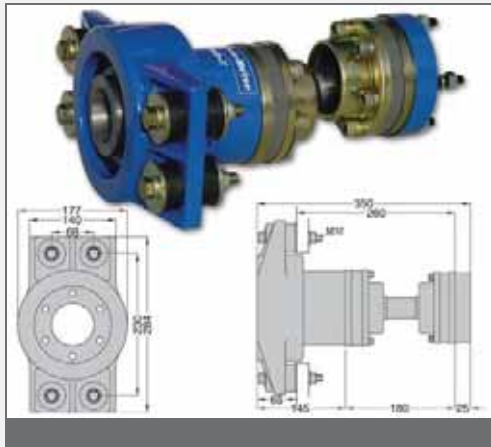

## Python-Drive P140-T

The Python-drive is supplied with a built-in length of 180 mm as a standard. Without a surcharge we can also offer a built-in length of 225 mm. Please state the desired built-in length when you order your P140-T.

Ø head cv shaft : 122 mm  
Pitch of bolts : 103,8 mm

Max. shaft torque (Kgm - Nm)	Shaft Ø (mm) (min - max)	Max. prop. thrust (kN)	Usage	Cat.no.
140 - 1370	40 - 55	18	160 HP/2500 rpm; 3:1 gearbox	P140-T
CV-shaft only (180 mm)				P140.180
CV-shaft only (225 mm)				P140.225

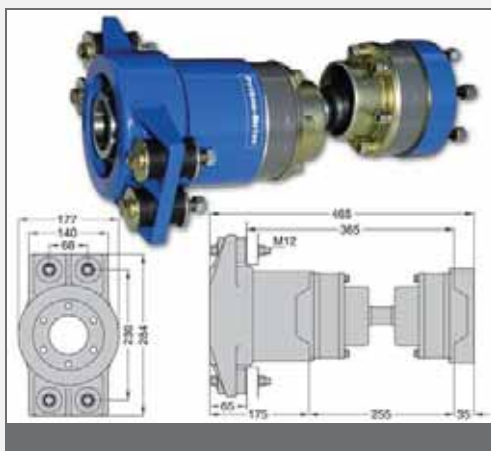

## Python-Drive P200-T

The Python-drive P200-T is supplied with a built-in length of 255 mm as a standard.

Ø head cv shaft : 148 mm  
Pitch of bolts : 128 mm

Max. shaft torque (Kgm - Nm)	Shaft Ø (mm) (min - max)	Max. prop. thrust (kN)	Usage	Cat.no.
200 - 1960	40 - 60	18	250 HP/2400 rpm; 2.5:1 gearbox	P200-T
CV-shaft only (255 mm)				P200.255

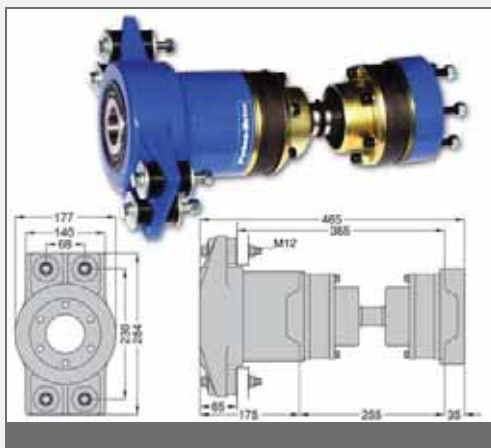

## Python-Drive P200-Q

The Python-drive P200-Q is supplied with a built-in length of 255 mm as a standard. This Python-drive is best used at no more than 1500 rpm.

Ø head cv shaft : 148 mm  
Pitch of bolts : 128 mm

Max. shaft torque (Kgm - Nm)	Shaft Ø (mm) (min - max)	Max. prop. thrust (kN)	Usage	Cat.no.
200 - 1960	45 - 60	22	200 HP/2200 rpm; 3:1 gearbox	P200-Q
CV-shaft only (255 mm)				P200.255

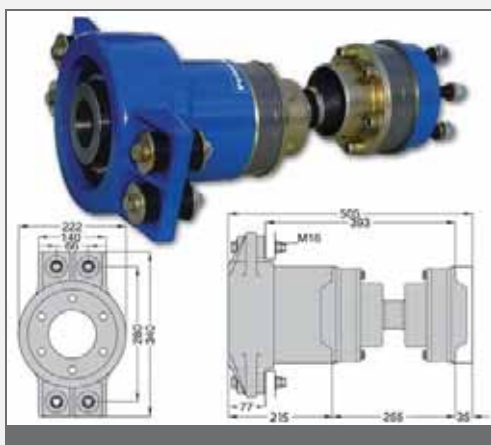

## Python-Drive P200-W

The Python-drive P200-W is supplied with a built-in length of 255 mm as a standard.

Ø head cv shaft : 148 mm  
Pitch of bolts : 128 mm

Max. shaft torque (Kgm - Nm)	Shaft Ø (mm) (min - max)	Max. prop. thrust (kN)	Usage	Cat.no.
200 - 1960	50 - 60	30	200 HP/2200 rpm; 3:1 gearbox	P200-W
CV-shaft only (255 mm)				P200.255

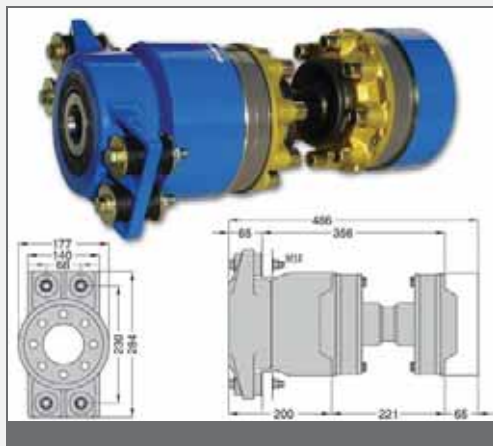

## Python-Drive P501-Q

The Python-drive P501-Q is supplied with a built-in length of 221 mm as a standard.

Ø head cv shaft : 191.8 mm  
Pitch of bolts : 165 mm

Max. shaft torque (Kgm - Nm)	Shaft Ø (mm) (min - max)	Max. prop. thrust (kN)	Usage	Cat.no.
500 - 4900	55 - 60	22	430 HP/2300 rpm; 2.5:1 gearbox	P501-Q
CV-shaft only (221 mm)				P501.221

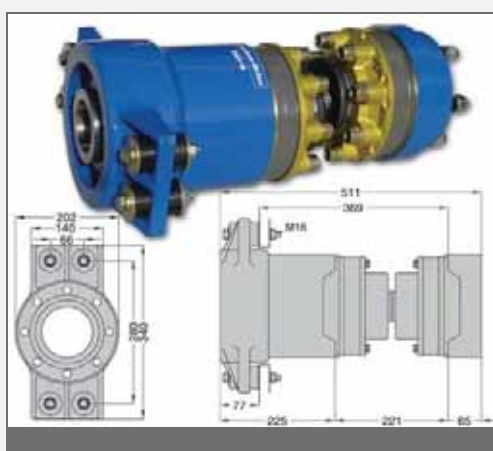

## Python-Drive P501-W

The Python-drive P501-W is supplied with a built-in length of 221 mm as a standard. Without a surcharge we can also offer a built-in length of 260 mm. Please state the desired built-in length when you order your P501-W.

Ø head cv shaft : 191.8 mm  
Pitch of bolts : 165 mm

Max. shaft torque (Kgm - Nm)	Shaft Ø (mm) (min - max)	Max. prop. thrust (kN)	Usage	Cat.no.
500 - 4900	60 - 80	30	620 HP/2400 rpm; 2.5:1 gearbox	P501-W
CV-shaft only (221 mm)				P501.221
CV-shaft only (260 mm)				P501.260

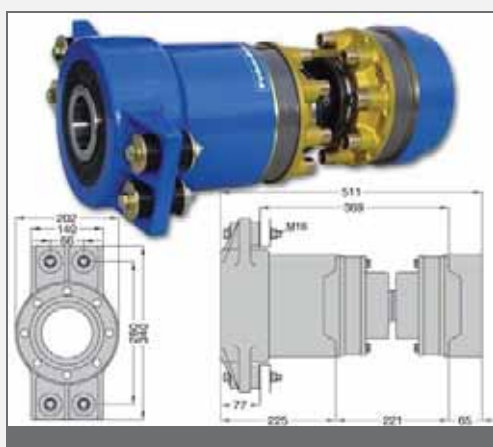

## Python-Drive P501-L

The Python-drive P501-L is supplied with a built-in length of 221 mm as a standard. Without a surcharge we can also offer a built-in length of 260 mm. Please state the desired built-in length when you order your P501-L.

Ø head cv shaft : 191.8 mm  
Pitch of bolts : 165 mm

Max. shaft torque (Kgm - Nm)	Shaft Ø (mm) (min - max)	Max. prop. thrust (kN)	Usage	Cat.no.
500 - 4900	60 - 80	45	420 HP/1900 rpm; 3:1 gearbox	P501-L
CV-shaft only (221 mm)				P501.221
CV-shaft only (260 mm)				P501.260